

HC-B 16-SML-67/M1PG21

Order No.: 1771642

The figure shows box mounting bases with supports

<http://eshop.phoenixcontact.de/phoenix/treeViewClick.do?UID=1771642>Box mounting base, with single locking latch, height 67 mm, with
screw connection, 1x Pg21

Commercial data

EAN	4017918036362
Pack	10 Pcs.
Customs tariff	76169910
Weight/Piece	0.38194 KG
Catalog page information	Page 403 (PC-2007)

Product notes

WEEE/RoHS-compliant since:
03/01/2006

<http://www.download.phoenixcontact.com>
Please note that the data given here has been taken from the online catalog. For comprehensive information and data, please refer to the user documentation. The General Terms and Conditions of Use apply to Internet downloads.

Technical data

General data

Note	For contact inserts HC-B16, BB32, D40, DD72, HS6, M, K
Design	B16
Height	67 mm
Width	57 mm
Length	117 mm

Housing type	Box mounting bases
Locking type	With single locking latch
Type of the screw connection	1x Pg21
Pg screw connection	With
Wrench size, union nut	28 mm
External cable diameter	10 mm ... 19 mm
Degree of protection	IP65
Ambient temperature (operation)	-40 °C ... 125 °C
Housing material	Aluminum, die-cast
Housing surface material	Powder-coated, gray
Seal material	NBR
Screw connection material	Nickel-plated brass
Cable seal material	NBR
Locking latch material	High-grade steel, handle: PA-GF
Material grip body interlock	PA-GF

Certificates / Approvals

Approval logo



requested approbations

Certification	GOST
---------------	------

Drawings

Dimensioned drawing

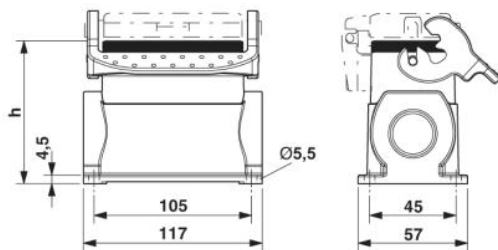

Address

PHOENIX CONTACT Inc., USA
586 Fulling Mill Road
Middletown, PA 17057, USA
Phone (800) 888-7388
Fax (717) 944-1625
<http://www.phoenixcon.com>



© 2008 Phoenix Contact
Technical modifications reserved;